

Castro in Toiriz

This Celtic fort, from the Iron Age, is formed by two fortified enclosures: the higher central platform or *croa*, Eira dos Mouros, and the terraced area of the *antecastro*, lower in elevation and towards the south and east. Between them they occupy an area of around two hectares.

Although the site is yet to be excavated, a magnetic survey using ground-penetrating radar in 2012 showed the layout of the existing structures, still underground. The intervention by AGi architects seeks to resurface the way in which the Celtic settlement occupied the headland in its day, avoiding invasive or imitative approaches, allowing the visitor to imagine the civilisation that inhabited this promontory thousands of years ago by means of its traces drawn over the landscape.

With this aim in mind, the design includes a series of pieces in Corten steel, placed on site almost as sketches in the landscape, replicating the structures that lie below ground. So, the pieces have a two-fold objective; to provide the visitor with an intuitive interpretation of the settlement below ground and to create a place that can be used by the local community and visitors.

The proposal strives to be sensitive towards the special nature of the promontory and its privileged views over to the west. Two landscape “*pikes*” are placed along the western boundary, making the most of the panoramic views and framing the nearest castros with which the ancient inhabitants of Toiriz would have established social and economic ties.

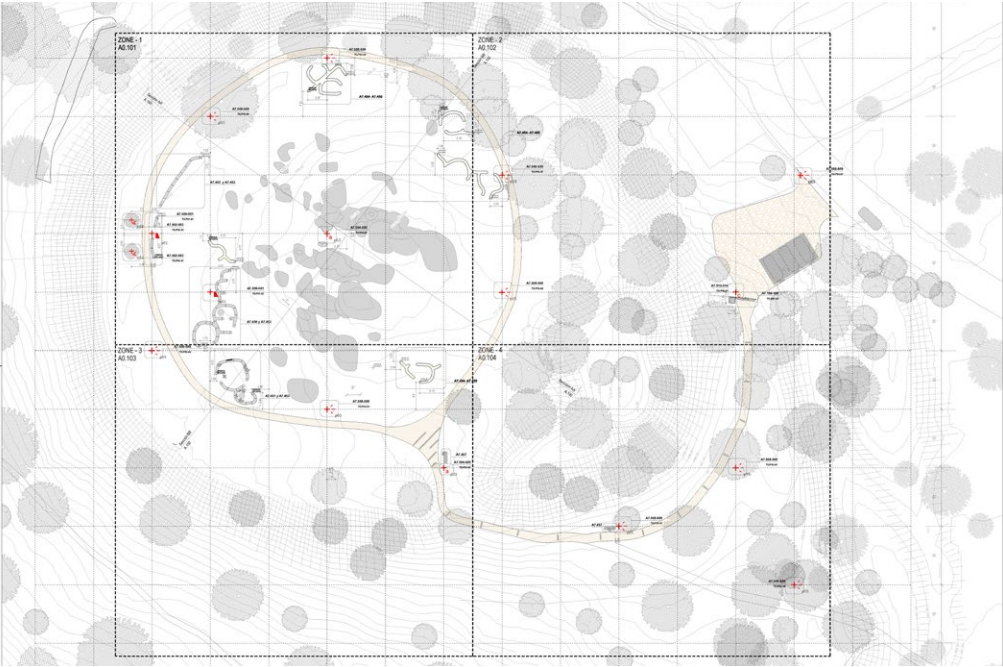

Previous state